

Loop Powered Door Magnet (ZTA-DH)



The loop powered door magnet is the latest innovation from Zeta Alarm Systems. The ZTA-DH is an addressable loop powered & loop controlled door holder. It takes all its power from the loop, so there is no need for a separate power supply or battery.

The unit consists of a controller unit, which connects directly to the loop, and a permanent magnet door holder. The door holder controller can then be programmed to operate in a similar manner to an Input/Output unit.

The current consumption allows the use of up to 20 units per loop.

It has a manual door release button to allow the magnet to release the door at any time.

The interface also has a built in loop short circuit isolator, to help maintain system integrity in the event of a fault condition.

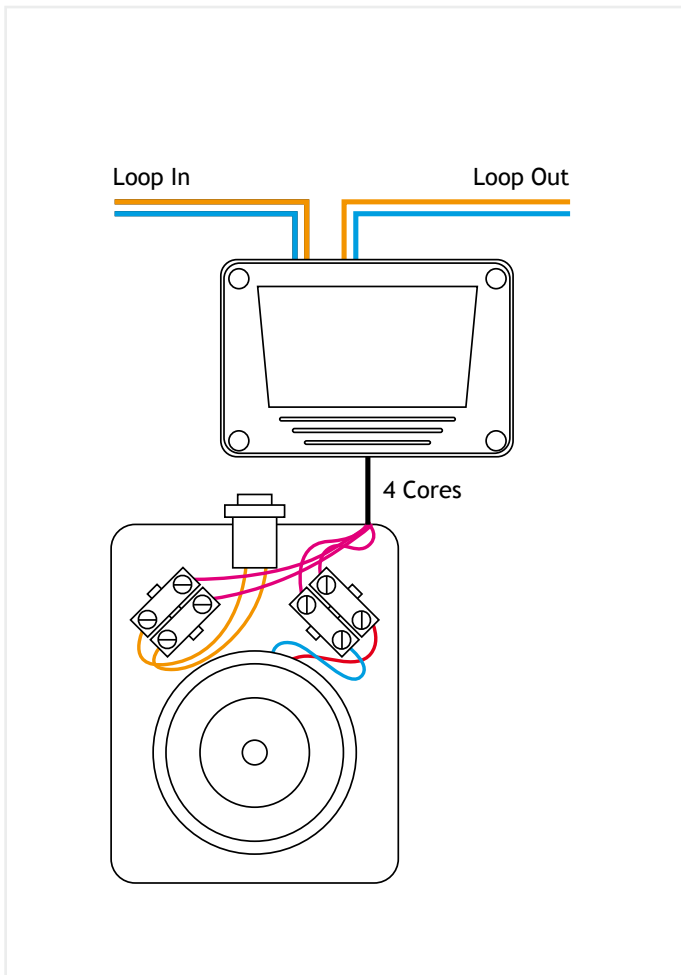

Model	ZTA-DH
Part No.	83-005
Supply Voltage	17-33V DC
Standby Current	1mA Typ (Max 13.5mA)
Active Current	4mA Typ (Max 16.6mA)
Inputs	Manual door release button
Output	Release signal to magnet
Operating Temp.	0°C to 60°C
Holding Force	200 N
Magnet Release Pwr	3 W
Size (interface)	127 x 88 x 59 mm
Weight (interface)	220g
Size (magnet)	85 x 110 x 38 mm
Weight (magnet)	400g
Size (keeper)	55 x 55 x 50 mm
Weight (keeper)	150g